



Composition of a planting site along a river environment

Caroline Hammelow Fridlund

Planting design and horticultural ecosystem management

Lecturer: Sabine Plenk BOKU - W2021

Atmospheric Illustration of the planting site

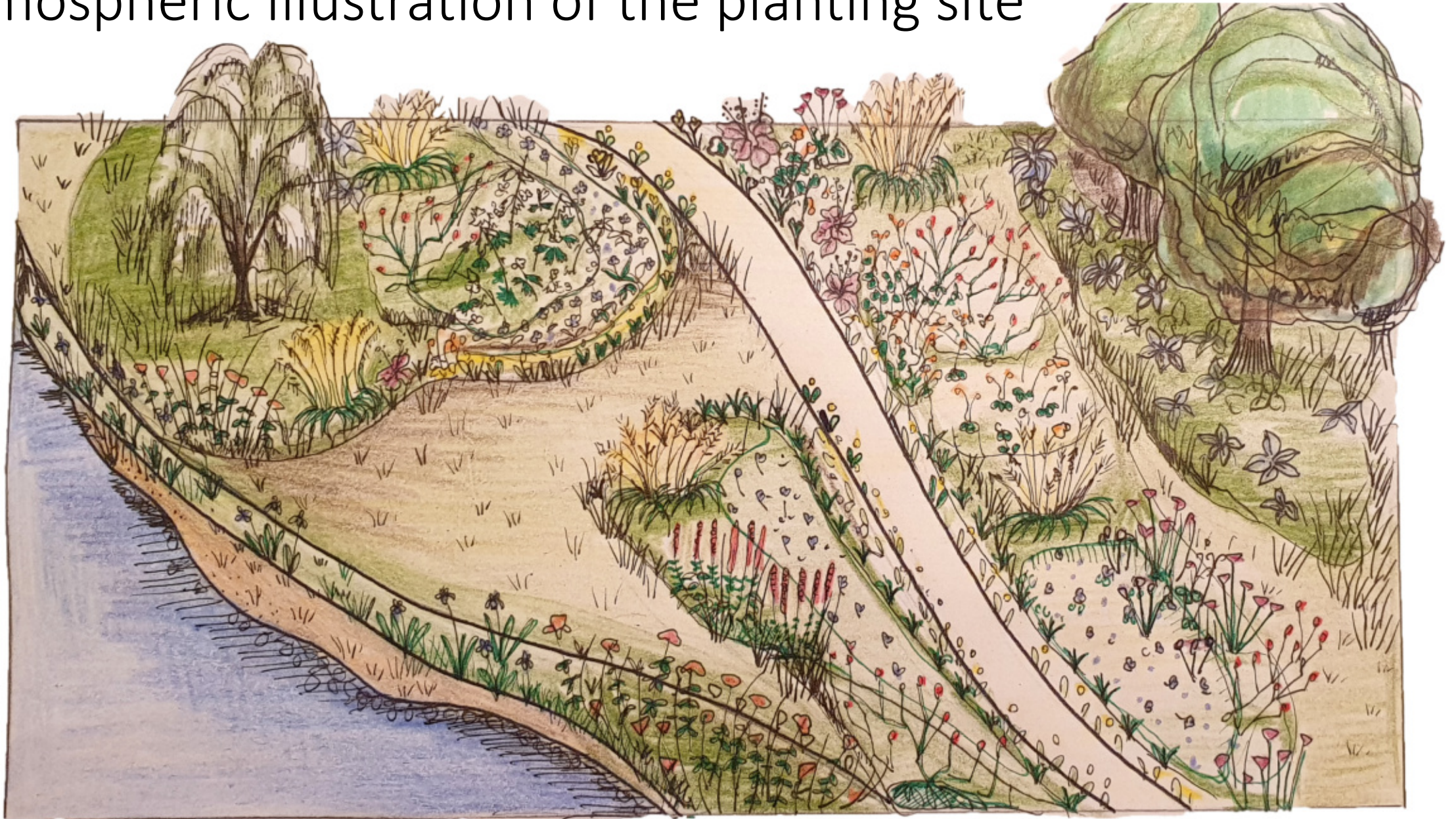

Information - Species

LATIN NAME	CULTIVAR	PLANT TYPE	SOIL	HARDINESS	WET TOLERANCE	LIGHT	FOLIAGE	MAINTENANCE	GROWTH HABIT
<i>Allium atropurpureum</i>		Perennial Bulb	Moist, well-drained	H6	Yes	Full sun	Green (NE)	Low	Upright
<i>Carex morrowii</i>	'Ice Dance'	Perennial	Moist	H4	Yes	Sun-partial	Dark green (E)	Low	Mounding/Clump
<i>Crocus chrysanthus</i>		Perennial Bulb	Moist, well-drained	H8	Medium	Sun-partial	Dark green (E)	Low	Tufted
<i>Eutrochium purpureum</i>	'Atropurpurea'	Perennial	Moist, well-drained	H6	Yes	Sun-partial	Green (NE)	Low	Clump forming
<i>Geum rivale</i>	'Leonards Variety'	Perennial	Moist, well-drained	H4	Yes	Sun-partial	Bright gr.(NE)	Average	Clump forming
<i>Heuchera</i>	'Sugar Plum'	Perennial	Moist, well-drained	H9	Medium	Sun-partial	Plum-purple (E)	Low	Mounding/Clump
<i>Hosta</i>	'Halcyon'	Perennial	Humus, well-drained	H7	Yes-no	Sun-partial	Bluegreen (E)	Low	Clump forming
<i>Iris sibirica</i>		Perennial	Moist, well-drained	H3-8	Yes	Sun-partial	Grass-like(E)	Low	Clump forming
<i>Lythrum salicaria L.</i>		Perennial	Moist, well-drained	H4	Yes	Sun-partial	Green (NE)	Low	Upright
<i>Molinia arundinacea</i>	'Transparent'	Perennial gras	High tolerance	H7	Yes	Sun-partial	Gr-Bronze(NE)	Low	Mounding
<i>Omphalodes cappadocia</i>		Perennial	Moist-well drained	H5	Medium	Sun-partial	Green (E)	Low	Clump forming
<i>Ranunculus aconitifolius</i>	'Flore Pleno'	Perennial	Moisture rententive	H8	Yes	Sun-Partial	Dark green(NE)	Low	Clump forming
<i>Salix babylonica</i>		Decidious tree	Wet tolerant	H6-8	Yes	Full sun	Decidious (NE)	Average	Fast-growing
<i>Sanguisorba officinalis</i>	'Great Burnet'	Perennial	Most types	H7	Mid	Sun-partial	Green (NE)	Low	Clump forming

NE = Not evergreen

E = Evergreen

Plant calendar - Foliage

Latin name	February	March	April	May	June	July	August	September	October	November
<i>Allium atropurpureum</i>										
<i>Carex morrowii</i> (E)										
<i>Crocus chrysanthus</i> (E)										
<i>Eutrochium purpureum</i>										
<i>Geum rivale</i>										
<i>Heuchera</i> (E)										
<i>Hosta</i> (E)										
<i>Iris sibirica</i> (E)										
<i>Lythrum salicaria</i> L.										
<i>Molinia arundinacea</i>										
<i>Omphalodes cappadocia</i> (E)										
<i>Ranunculus aconitifolius</i>										
<i>Salix babylonica</i>										
<i>Sanguisorba officinalis</i>										

E = Evergreen

Technical plantplan

REFERENCE	LATIN NAME	CULTIVAR	HEIGHT	COUNT	PLANT DISTANCE C-C	SPREAD
Al	<i>Allium atropurpureum</i>		0.6-0.9 m	6	0.2 m	0.3-0.6 m
Ca	<i>Carex morrowii</i>	'Ice Dance'	0.3 m	26	0.4 m	0.3-0.6 m
Cr	<i>Crocus chrysanthus</i>		0.1-0.15m	265	0.07 m	0.07 m
Eu	<i>Eutrochium purpureum</i>	'Atropurpurea'	1.5-2.0 m	4	1.2-1.8 m	0.6-1.2 m
Ge	<i>Geum rivale</i>	'Leonards Variety'	0.1-0.5 m	10	0.3-0.45 m	0.45-0.75 m
He	<i>Heuchera</i>	'Sugar Plum'	0.3-0.9 m	3	0.45 m	0.45 m
Ho	<i>Hosta</i>	'Halcyon'	0.4 m	15	1.2 m	0.9-1.2 m
Ir	<i>Iris sibirica</i>		1.2 m	10	0.3-0.6 m	0.3-0.6 m
Ly	<i>Lythrum salicaria L.</i>		0.5-1.50m	10	0.3 m	
Mo	<i>Molinia arundinacea</i>	'Transparent'	1.0 m	6	1-3/m2	0.4-0.6m
Om	<i>Omphalodes cappadocia</i>		0.15-0.22m	42	0.22-0.3 m	0.22-0.3m
Ra	<i>Ranunculus aconitifolius</i>	'Flore Pleno'	1 m	6	0.5 m	0.4 m
S	<i>Salix babylonica</i>		9-15 m	1	9-15 m	
Sa	<i>Sanguisorba officinalis</i>	'Great Burnet'	1.2 m	5	0.6-0.9 m	0.6-0.9 m

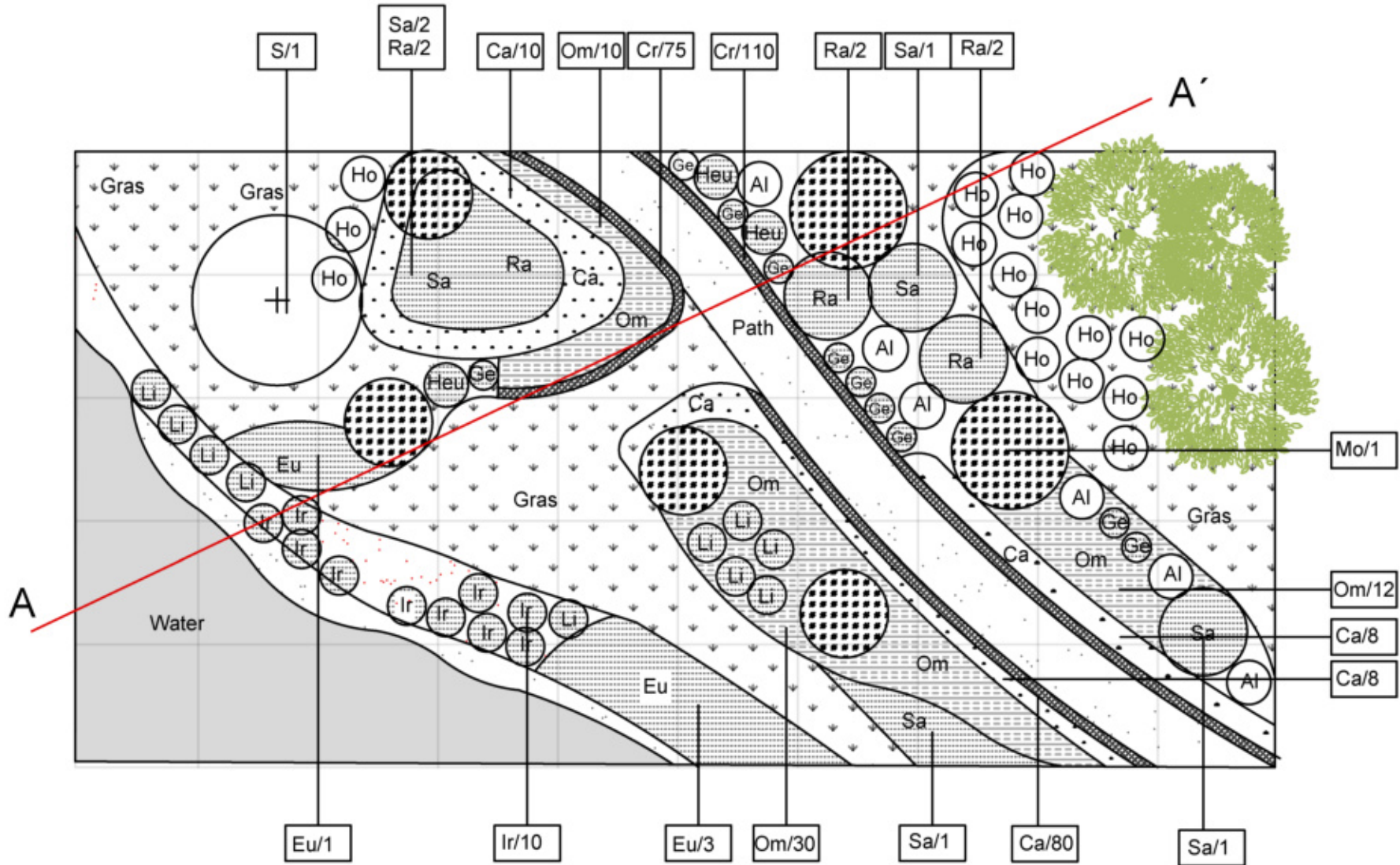

Description

- Gravel
- Gras, forrestground
- Water
- Perennials/Herbaceous
- Bulb**
 - Allium atropurpureum*
 - Crocus chrysanthus*
- Fillers, Evergreen**
 - Carex Morrowii*
 - Omphalodes cappadocia*
- Ornamental**
 - Molinia arundinacea*
- Trees**
 - Existing
 - New

M 1:50 35 m²
50 m²

Schnittansicht A-A'

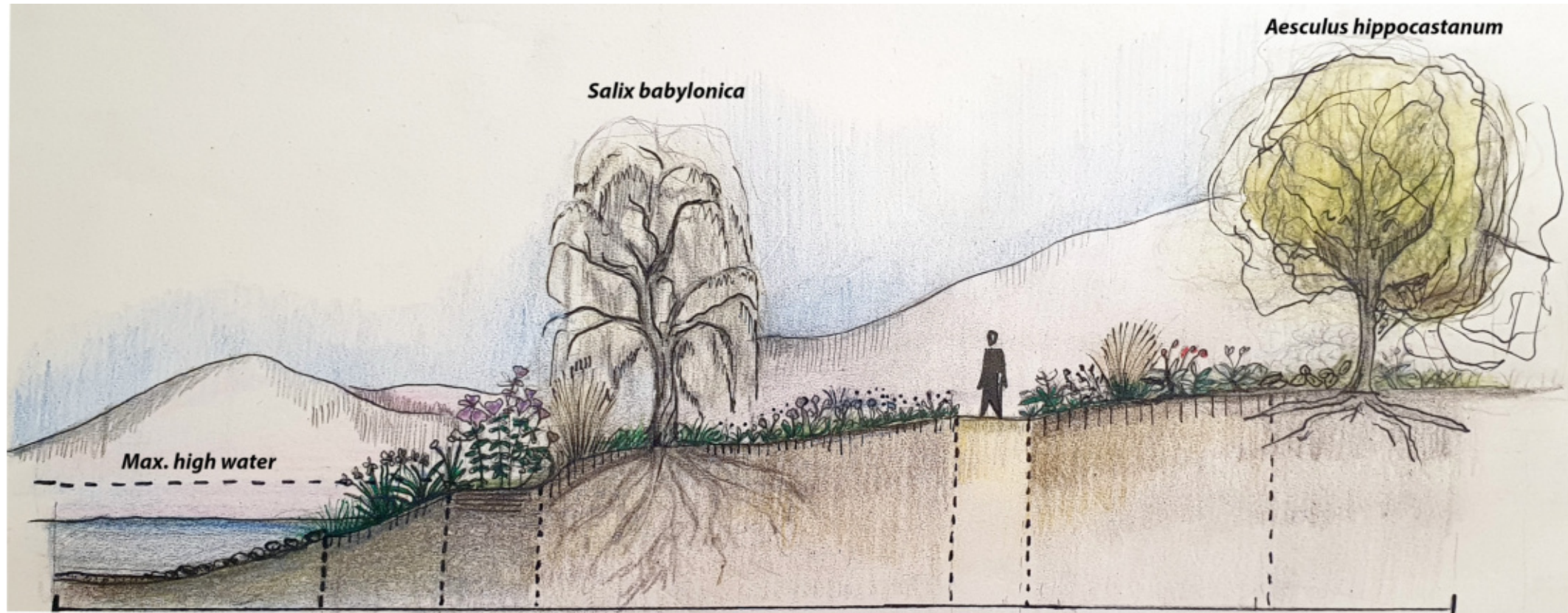

A

WATER

Different water depths for naturally floating plants or underwater plants.

WATEREDGE

Fresh to moist soil
Wet, occasionally flooded ground.

OPEN SPACE

More drier ground

PATH

WOODED EDGE

Sunny and warmer area

A'

M 1:100

Location 1

Along pathway (North-East)



Allium atropurpureum

Sanguisorba officinalis 'Great Burnet'

Heuchera 'Sugar Plum'

Geum Rivale 'Leonards Variety'

Molinia arundinacea 'Transparent'

Hosta 'Halycon'

Crocus chrysanthus

Along pathway



Location 2

Along pathway (South-East)



Carex morrowii 'Ice Dance'

Omphalodes Cappadocia

Crocus chrysanthus

Geum Rivale 'Leonards Variety'

Molinia arundinacea 'Transparent'

Allium atropurpureum

Sanguisorba officinalis 'Great Burnet'



Location 3

Along river-pathway (North)

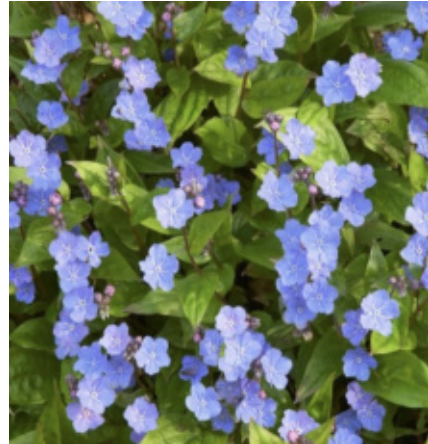
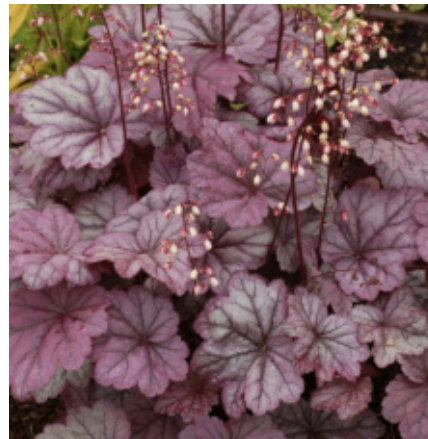

Heuchera 'Sugar Plum'

Sanguisorba officinalis 'Great Burnet'

Carex morrowii 'Ice Dance'

Omphalodes Cappadocia

Ranunculus aconitifolius 'Flore Pleno'

Crocus chrysanthus

Geum Rivale 'Leonards Variety'

Molinia arundinacea 'Transparent'

Salix babylonica

Location 4

Along river (South)

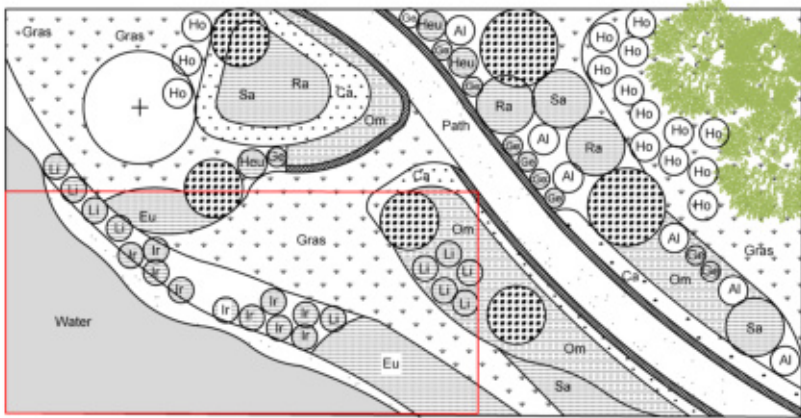

Lythrum salicaria L.

Geum Rivale 'Leonards Variety'

Iris sibirica

Molinia arundinacea 'Transparent'

Carex morrowii 'Ice Dance'

Eutrochium purpureum 'Atropurpurea'



Along river composition



Resources

- <https://www.vestplant.no/>
- <https://www.park-anlegg.no/>
- <https://www.rolv.no/>
- <https://planter.bjorkan.no/>
- <https://www.artsdatabanken.no/>
- <https://www.vestplant.no/plants/lythrum-salicaria/>
- <https://www.vestplant.no/plants/carex-morrowii-ice-dance/>
- <https://www.vestplant.no/plants/iris-sibirica/>
- <https://www.gardenersworld.com/plants/allium-atropurpureum/>
- <https://www.gardenersworld.com/plants/molinia-caerulea-subsp-arundinacea-transparent/>
- <https://www.gardenersworld.com/plants/ranunculus-acontifolius-flore-pleno/>
- <https://www.gardenia.net/plant/geum-rivale-leonard-variety>
- <https://www.gardenia.net/plants/plant-family/crocus>
- <https://www.gardenia.net/plant/lythrum-salicaria-purple-loosetrife>
- <https://www.gardenia.net/plant/omphalodes-cappadocica>
- <https://www.gardenia.net/plant/salix-babylonica>
- <https://plants.ces.ncsu.edu/plants/eutrochium-purpureum/>
- <https://www.gardenia.net/plant/eutrochium-fistulosum>
- <https://www.rhs.org.uk/plants/91856/crocus-chrysanthus-cream-beauty/details>
- <https://www.gardenia.net/plant/sanguisorba-officinalis>

Mostly used resources for research about the different characteristics of the species

- Artsdatabanken
- Urtekilden
- Gardenersworld
- Vestplant
- Gardenia
- Park og Anlegg
- Bjorkan

Pictures

- <https://www.gardenia.net/plant/omphalodes-cappadocica>
- <https://www.veseys.com/ca/atropurpureum-allium-70132.html>
- <https://horlingsplants.ca/products/carex-oshimensis-ice-cream>
- <https://www.fluwel.com/crocus-romance.html>
- <https://www.gardenia.net/plant/eutrochium-fistulosum>
- https://www.rolv.no/urtemedisin/medisinplanter/geum_riv.htm
- <https://www.vestplant.no/plants/hosta-tardiana-halcyon/>
- <https://www.dreamstime.com/iris-sibirica-beautiful-blue-flowers-siberian-blooming-garden-image174531499>
- https://ukrbin.com/show_image.php?imageid=137849
- <https://www.baumschule-horstmann.de/shop/exec/product/692/11240/Riesen-Pfeifengras-Transparent.html>
- <https://alchetron.com/Ranunculus-aconitifolius>
- <https://www.amazon.com/Weeping-Willow-Cuttings-Smaller-Babylonica/dp/B0914R9W7D>
- <https://www.gardenia.net/plant/sanguisorba-officinalis>