

# WATER & DROUGHT

## ANALYSIS

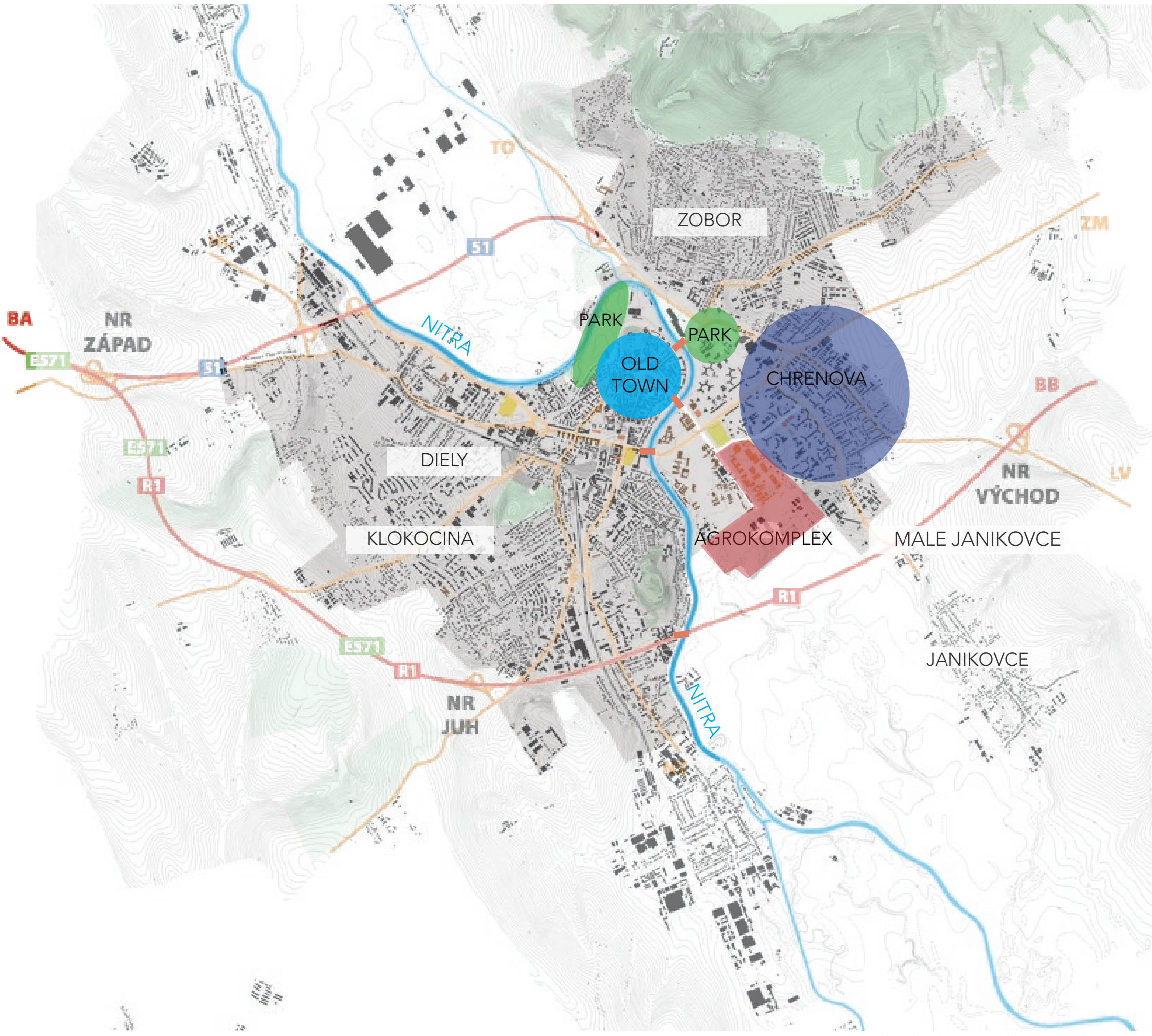

SOURCE: <https://www.agrokomplex.sk/en/vystavisko/navigacia-na-vystavisko/>

## SITE SURFACE ANALYSIS



TOTAL  
≈ 967.800 m<sup>2</sup>

WATER SURFACE  
≈ 62.400 m<sup>2</sup>

GREEN  
≈ 630.285 m<sup>2</sup>

BUILDINGS 64 STK.  
≈ 75.100 m<sup>2</sup>

SEALED SURFACE  
≈ 200.000 m<sup>2</sup>

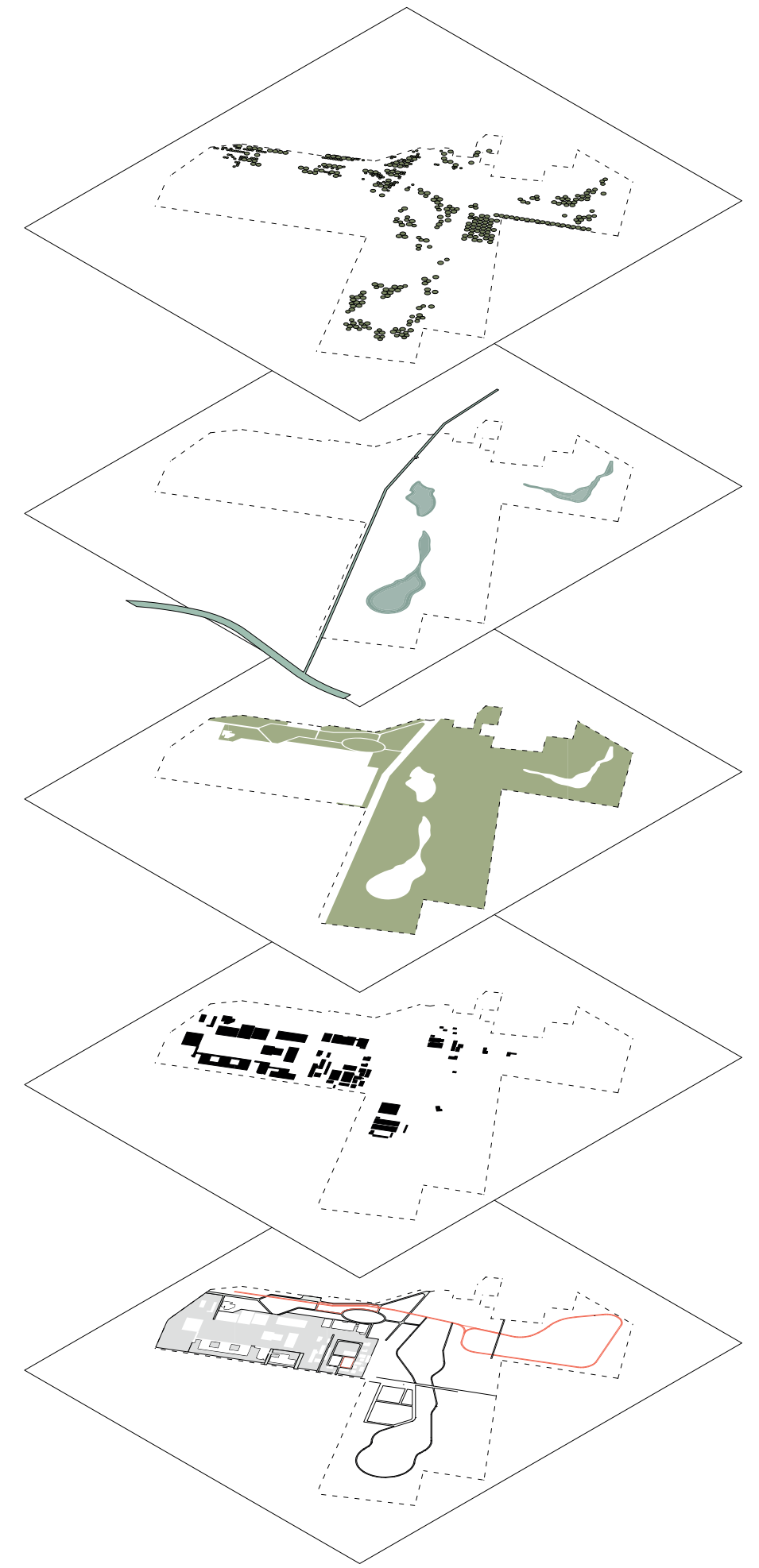

## DEVELOPMENT OVER TIME

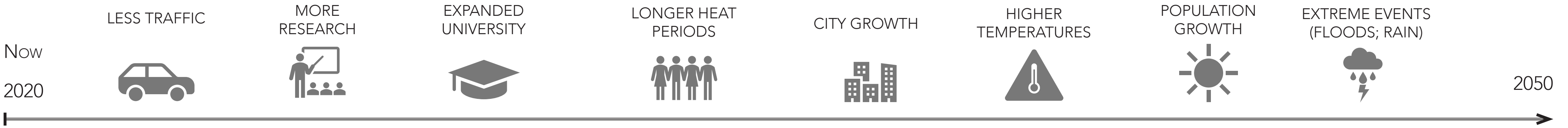

## MAIN GOALS

- RESILIENCE**  
adapt to extreme drought as well as to extreme rain fall and flooding events
- RECREATION**  
a park, where people can spend their freetime and enjoy fresh air and peace
- WATER SECURITY**  
water management program, which is able to collect, store, clean and re-use water
- HIGH BIODIVERSITY**  
Core Areas containing large healthy, functioning ecosystems

## STORYLINE

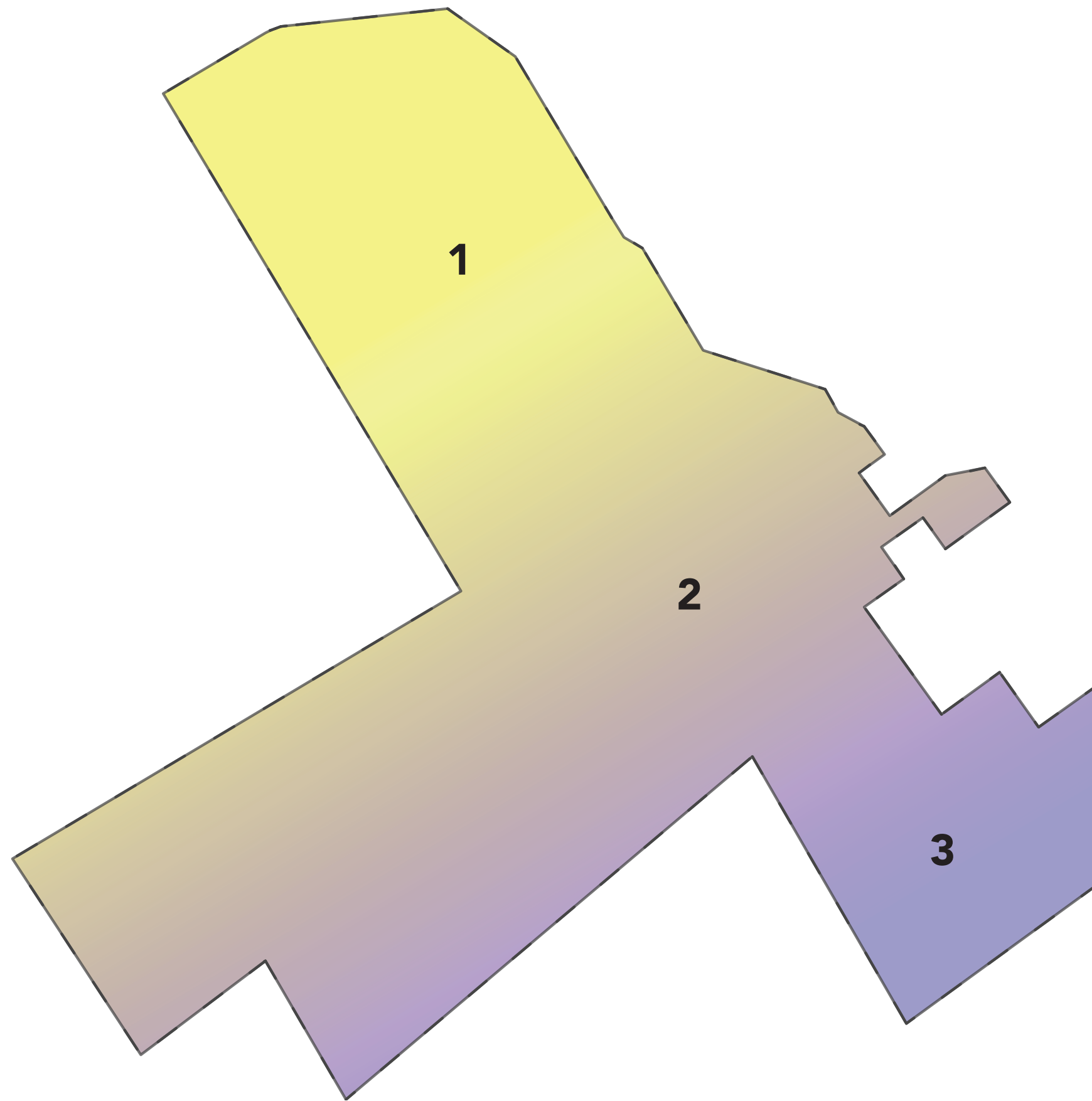

- TYPE 1**  
**PUBLIC CENTRAL SQUARE**  
EVENTS, EXHIBITIONS, MARKETS, HUMAN AMUSEMENT  
MOSTLY SEALED SURFACE  
SOME BUILDINGS ARE ELIMINATED TO AMPLIFY THE SIZE OF THE SQUARE  
SQUARE ALLOWS FLOODING  
LITTLE VEGETATION, SOME XERISCAPES
- TYPE 2**  
**PUBLIC PARK FOR RECREATION**  
MOSTLY UNSEALED SURFACE  
EXISTING BUILDINGS ARE ELIMINATED  
FOCUS ON WATERFRONTS OF THE LAKES (DESIGN FOR HUMAN USE)
- TYPE 3**  
**NATURALLY DESIGNED PUBLIC PARK**  
HIGH BIODIVERSITY  
UNSEALED SURFACE ONLY  
EXISTING BUILDINGS ARE ELIMINATED  
FOCUS ON WATERFRONTS OF THE LAKES (NATURAL PROCESSES)

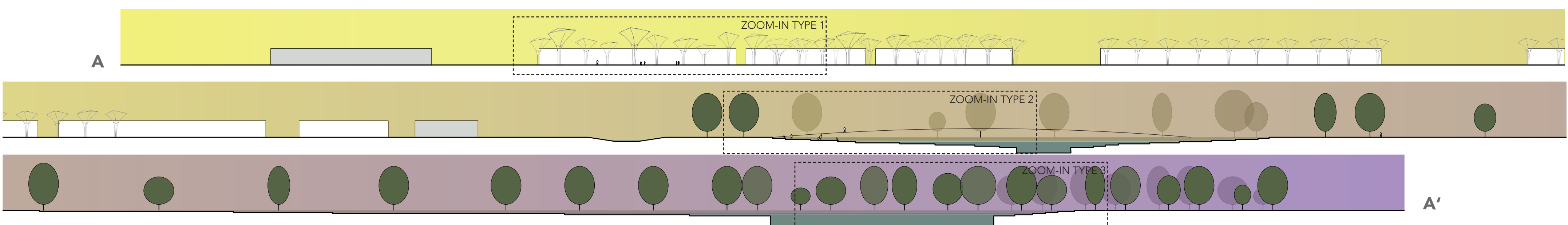

SECTION AA' TYPE 1 - TYPE 3 | M 1:1000



**SZENARIO**

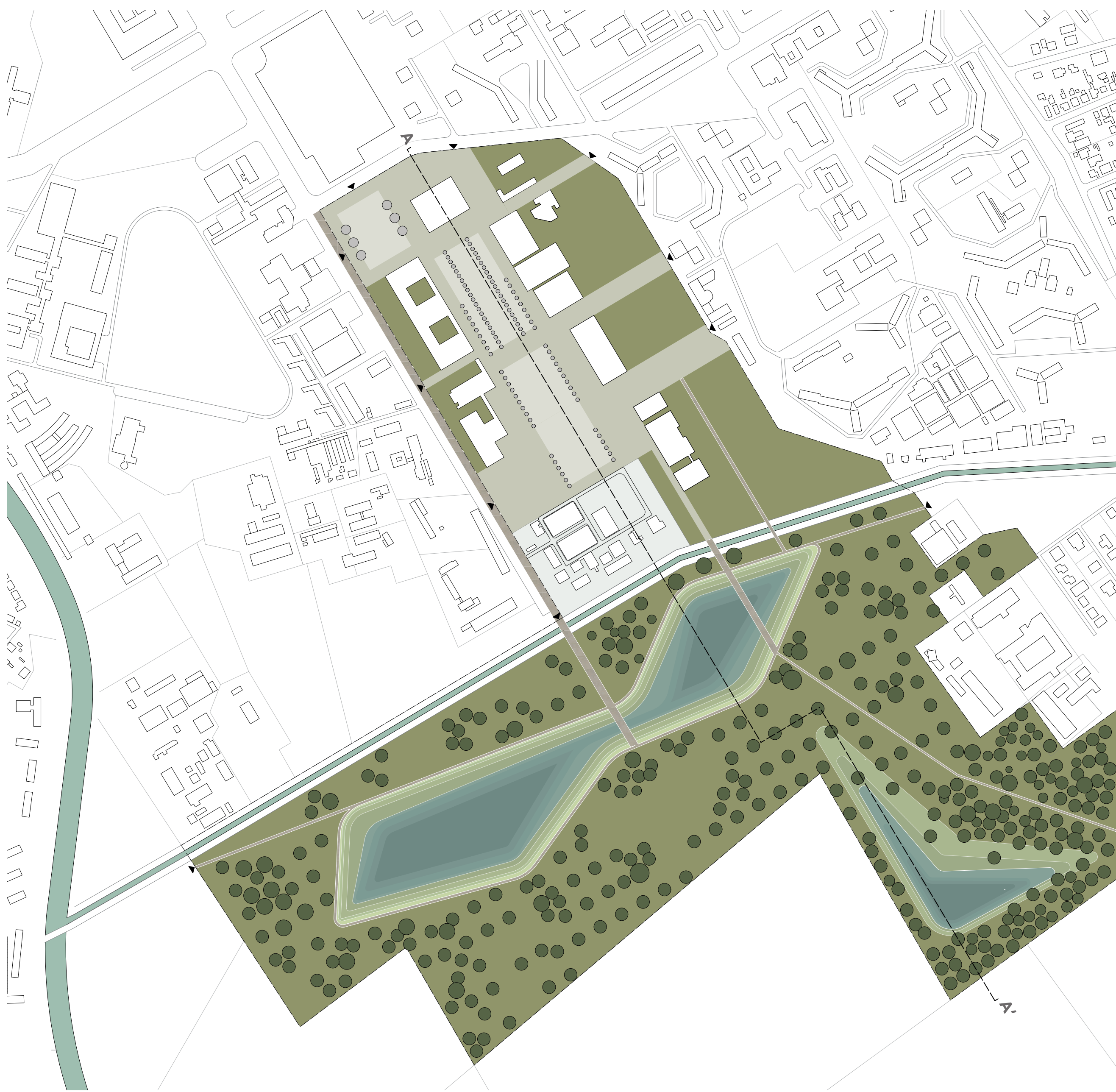

GROUNDPLAN AGROKOMPLEX | M 1:5000

**INSPIRATIONS TYPE 1 - TYPE 3**

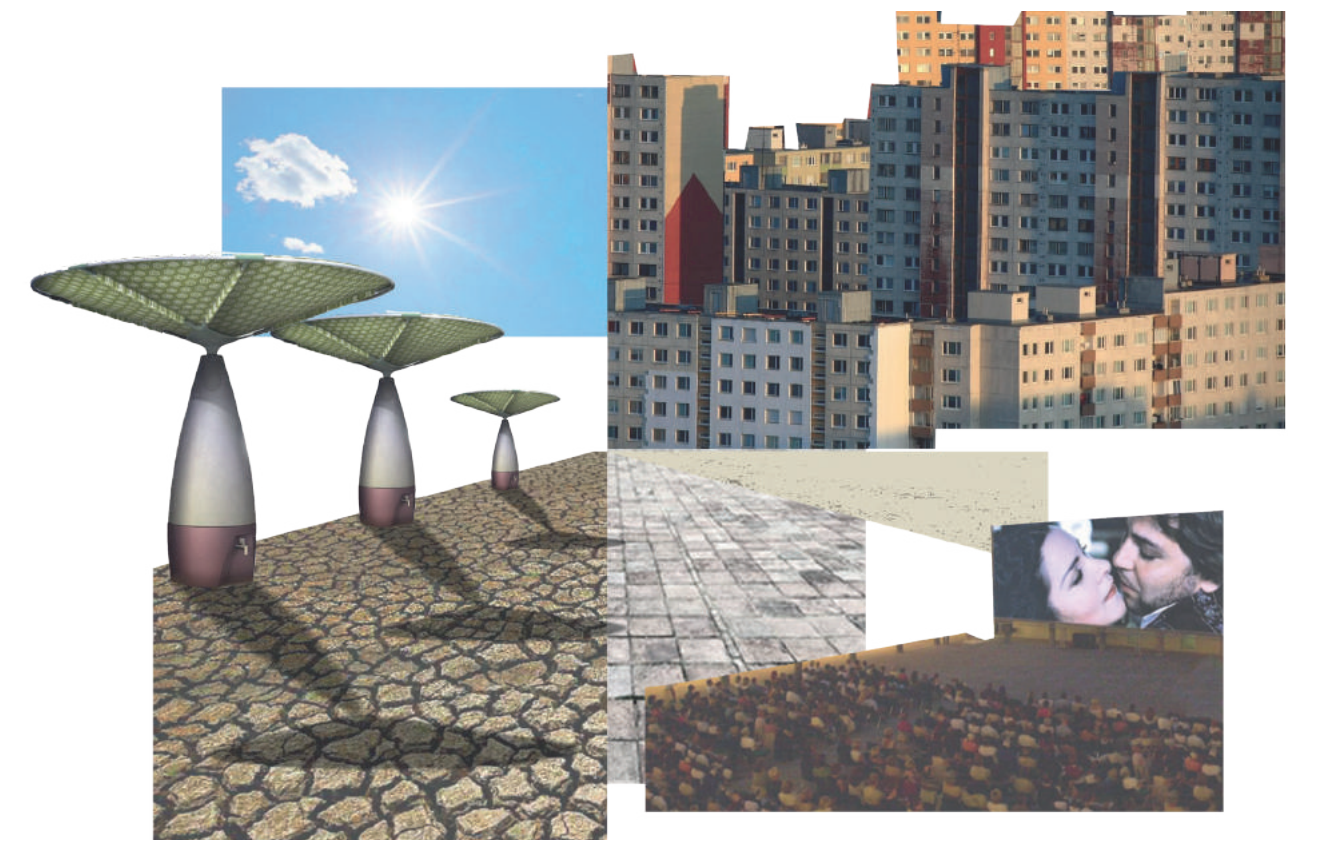

MOOD - PUBLIC SQUARE - TYPE 1



MOOD - PUBLIC PARK - TYPE 2



MOOD - NATURAL DESIGN - TYPE 3

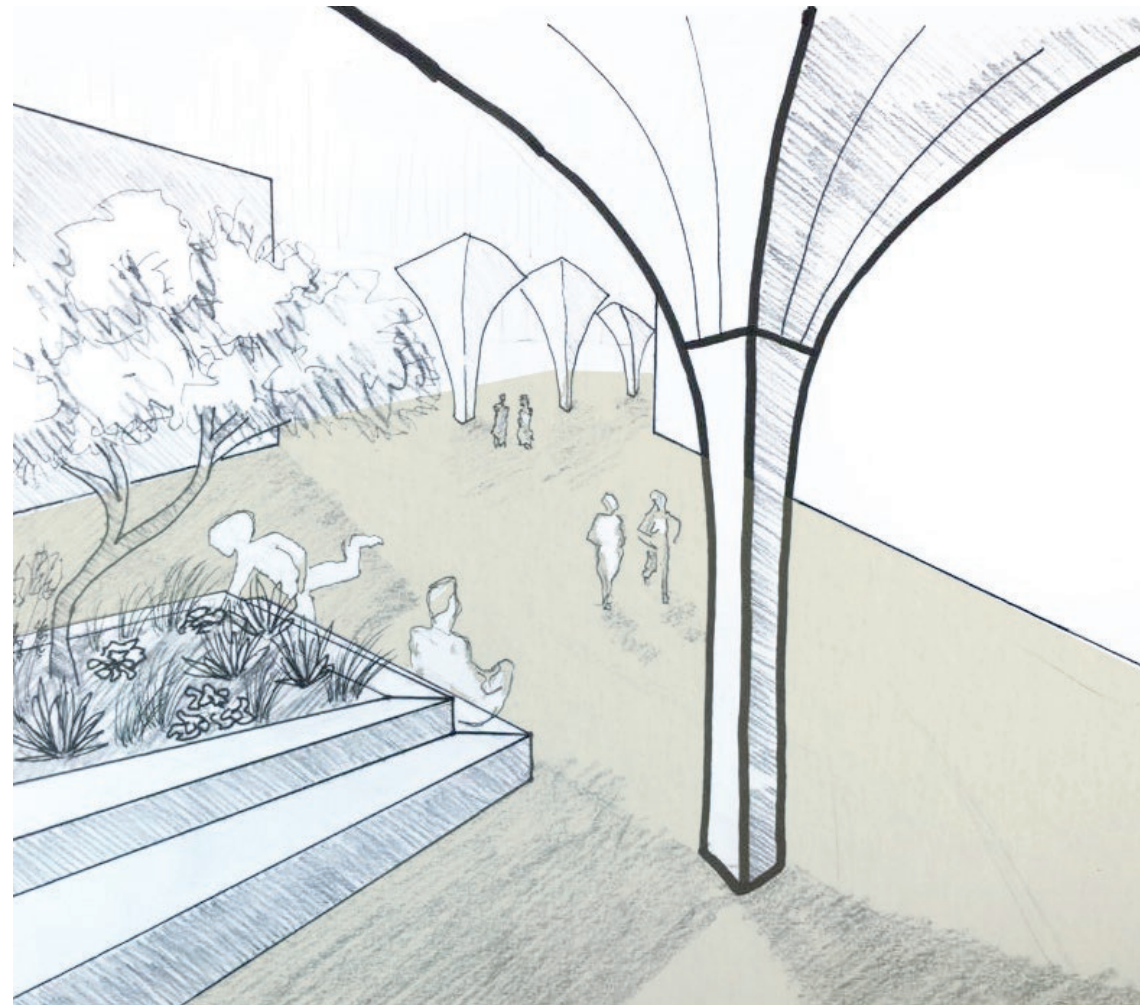
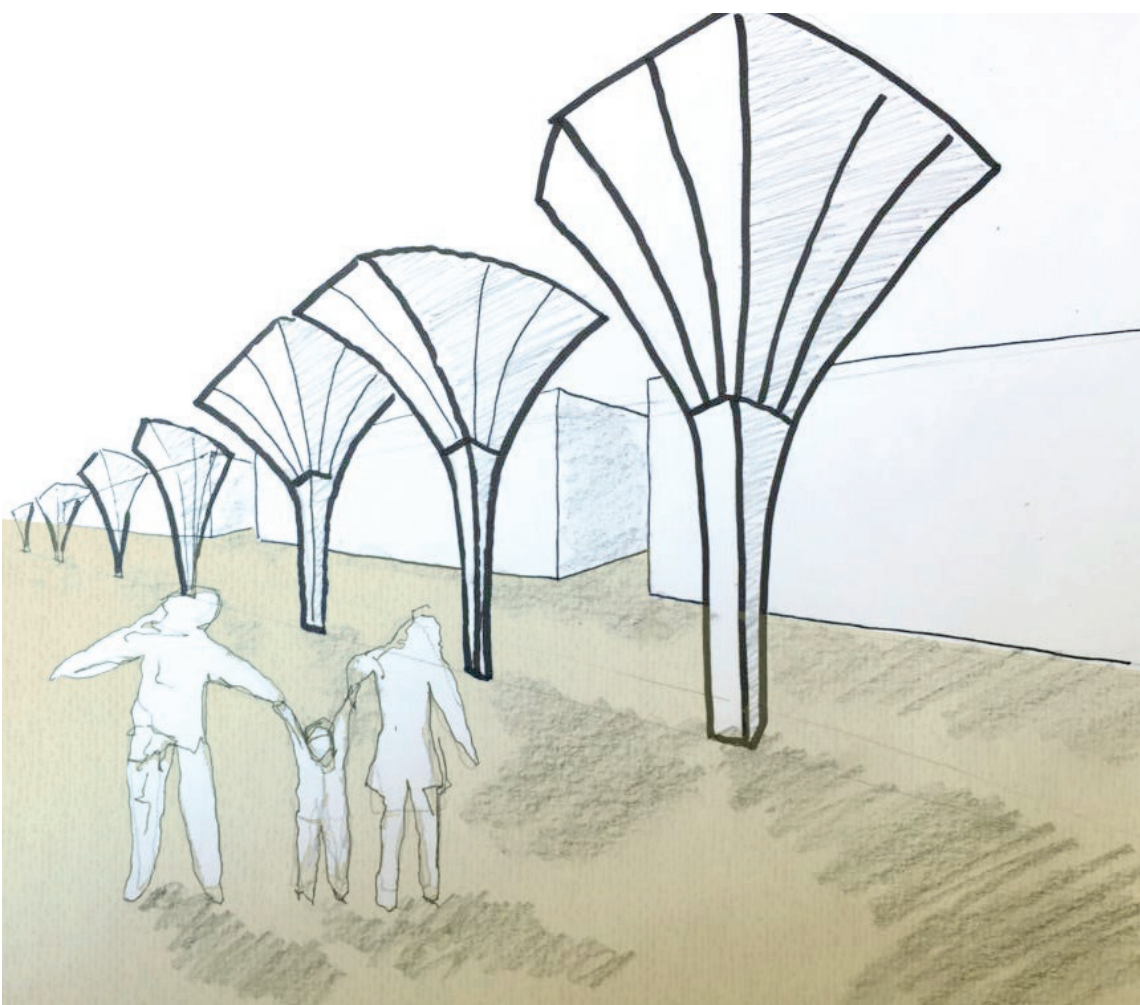

PERSPECTIVES

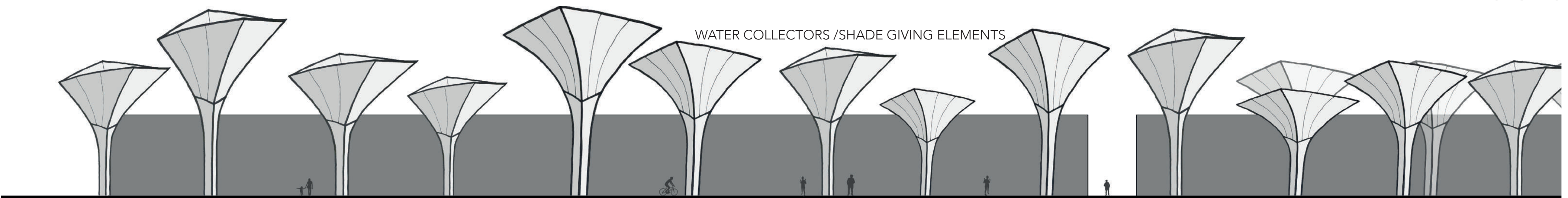

WATER COLLECTORS / SHADE GIVING ELEMENTS

ZOOM-IN SECTION AA' TYPE 1 | M 1:200

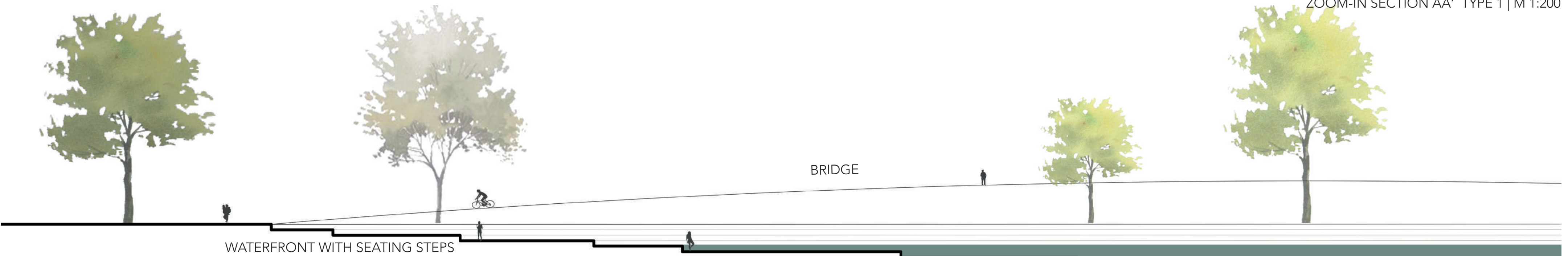

WATERFRONT WITH SEATING STEPS

BRIDGE

ZOOM-IN SECTION AA' TYPE 2 | M 1:200



WATERFRONT DESIGNED TO ALLOW NATURAL PROCESSES

ZOOM-IN SECTION AA' TYPE 3 | M 1:200